

# Santa Pillow

*Approximate Finished Size: 17" x 17"*

*Whether you've been naughty or nice, Santa will keep you company all through the holiday season. This easy appliqué pillow will bring a splash of color and cheer to your seasonal décor.*

## Fabric Requirements (as shown)

- 5/8 yard Solid Cuddle® 3 Cardinal, for pillow body
- 1/4 yard Luxe Cuddle® Marble Snow, for band
- 1/4 yard Solid Cuddle® 3 Black, for belt
- 6" x 6" square Solid Cuddle® 3 Silver, for belt buckle

*Note: Substitute shiny silver vinyl for a fun look!*

## Suggested Notions

- 16" all-purpose zipper, red
- Wash-away, double-sided tape, 1/4"
- 3 (1") jingle bells
- Batting, 2 (18" x 18") squares
- Polyester filling for stuffing or an 18" square pillow form
- 90/14 stretch machine needle
- Polyester thread
- Felt tip marker or ballpoint pen
- Rotary cutter and mat
- Micro-serrated scissors and/or craft knife
- Long, flower head pins and/or fabric clips
- Point turner
- Basting spray
- Walking foot



For more information on sewing with Cuddle®, scan the QR code or go to: [offers.shannonfabrics.com/beginner](https://offers.shannonfabrics.com/beginner)

**Shannon**  
F A B R I C S

The information in this pattern is presented in good faith.  
Every effort has been taken to assure the accuracy herein.

© 2021 Shannon Fabrics Inc., 3131 S. Alameda St., Los Angeles, CA 90058  
[info@shannonfabrics.com](mailto:info@shannonfabrics.com) | [www.shannonfabrics.com](http://www.shannonfabrics.com) | 866.624.5252

37.SBP

**Shannon**  
F A B R I C S  
Making The World A Softer Place

# Santa Pillow



# Santa Pillow

Approximate Finished Size: 17" x 17"

## DIRECTIONS

- Read *Cuddle® Basics* before beginning.



## Cutting

1. From Cardinal and batting, cut:
  - 2 (18" x 18") squares.
2. From Marble Snow, cut:
  - 1 (4" x 18") strip for band.
3. From Black, cut:
  - 1 (3¼" x 18") strip for belt.
4. From Silver, cut:
  - 1 (6" x 5") rectangle for the belt buckle. On the wrong side, mark a rectangle 1" from the top, bottom, and sides. Remove the inner section.

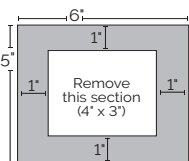

## Assembly

Arrange the appliqués

1. Spray baste a batting square to the wrong side of the Front and Back.
2. Baste the batting ⅜" from the edge. Trim batting from the seam allowance.
3. Appliqué pieces will be arranged on the Front, as shown—with the nap running down. After checking placement, remove pieces and set them aside.

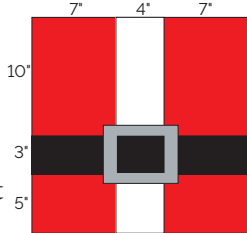

## Add the appliqués

Appliqué pieces in this order:

- White band
- Black belt
- Silver buckle

All pieces use the following process.

1. Spray baste the wrong side of the appliqué piece.
2. Smooth it into place.
3. Change the top thread color to match the appliqué piece.
4. Zigzag or blanket stitch around the edge. For the buckle, stitch the inside and outside edges.

## Assembly

Mark the corners

1. On the wrong side of the Front, make a mark ½" and 5" from each corner. There will be 4 marks on each edge.

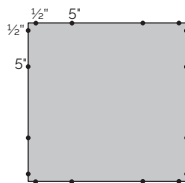

2. At each corner, draw a line connecting the ½" mark to the 5" mark on the adjacent side. These lines will intersect near the corner.

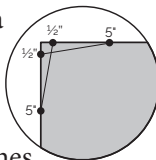

*Note: These marks are seam allowance guidelines. Slightly reducing the angles at the corners eliminates "dog ears"—those floppy things that are cute on puppies, but not on pillows.*

3. Repeat at each corner.

## Insert zipper

1. Place the appliquéd Front, *right side up*, on a flat surface.
2. Apply double-stick tape along the lower cut edge on the right side.
3. Center zipper, *wrong side up*, along the length of the double-stick tape. Press to adhere.
4. Sew the zipper tape in place.
5. Adhere double-stick tape, then sew the other side of the zipper to the right side of the pillow Back.

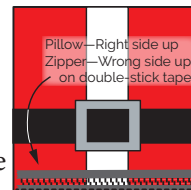

*Note: Position the Back with the nap also running toward the zipper.*

## Finishing

1. Open the zipper about 6".

*Note: The opening is needed to turn the pillow right side out after sewing the sides.*

2. With right sides together, double pin the remaining sides.
3. Start sewing 1" from the right hand side.
4. Sew around the 3 sides of the pillow. Use the marked lines on each corner as the guide for the ½" seam allowance. Raise the presser foot with the needle down to pivot at each corner. Finish 1" from the left edge of the pillow.

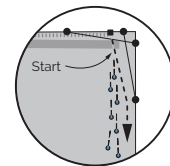
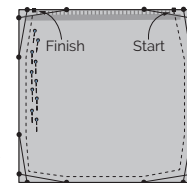

*Note: Backstitch at start and end to add strength to zipper insertion.*

5. Turn the pillow right side out.
6. Gently push out the corners using a point turner.
7. Sew the jingle bells securely to the Front Band.
8. Insert the pillow form, giving a little extra attention to getting the corners filled.

## Cuddle® Basics

1. Mark measurements on reverse side of Cuddle® with a felt tip marker or ballpoint pen.
2. Cut Cuddle® with a rotary cutter, craft knife, or scissors.
3. Shake cut pieces or put in a no-heat dryer with a damp washcloth for a few minutes to remove loose fibers.
4. Sew with polyester thread in the top and the bobbin.
5. Reduce presser foot pressure when sewing multiple layers.

6. Increase stitch length to 3–4 mm.
7. Double pin by using 2 rows of pins—the first row every 1½" along the seam line and a second row 1" to the left and parallel to the cut edge.
8. Backstitch at the beginning and end of each seam.
9. Seam allowances are ½" unless otherwise noted.
10. Use an even-feed or walking foot, if possible. It makes a difference!

